

# How to access databases, e-journals and e-books from off-campus.

## EZproxy

EZproxy is a service contracted by the University of Tokyo allowing members to access electronic resources (databases, e-journals, e-books) from their home or other off-campus locations.

### How to use

#### Sign in

You will need your UTokyo Account to use EZproxy.

\*Please use this service without connecting to UTokyo VPN.



#### On service

While using EZproxy, “.utokyo.idm.oclc.org” will be displayed in the URL.



#### Sign out

There is no sign out button.

When you exit EZproxy, **please close your browser completely.**

For more  
information

#### Using EZproxy

<https://www.lib.u-tokyo.ac.jp/en/library/literacy/user-guide/campus/offcampus/ezproxy>

Academic Information Literacy Section, ITG, The University of Tokyo  
2025.2  
literacy@lib.u-tokyo.ac.jp

# How to use the database

## 1. Select a database.

Access the “Database List” on the University of Tokyo Library System

<https://www.lib.u-tokyo.ac.jp/en/library/contents/database>

Select a database.

Click on the “Access to database (EZproxy)”.

Please read the notes carefully before using the database.

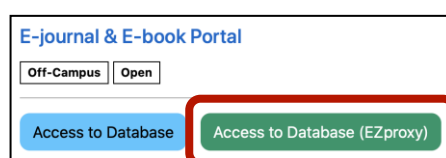
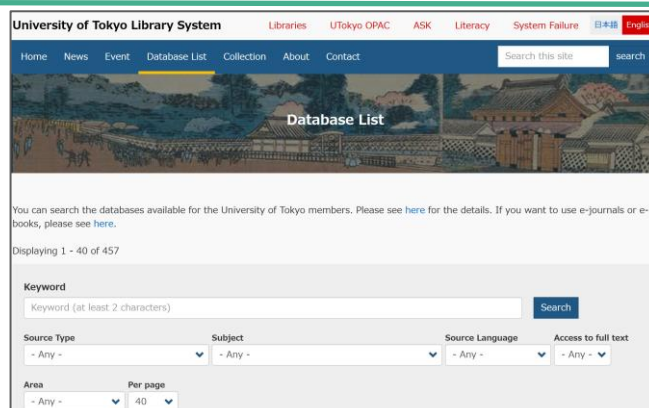

(Simultaneous users:2) Click on 'Log off' after usage.

## 2. Signing in to EZproxy

You will be taken to the UTokyo Account sign in page, sign in with your UTokyo Account.



The top page of the database will be displayed.

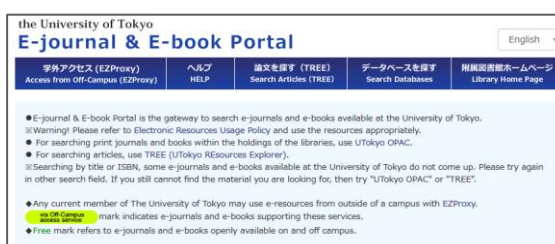

## 3. Signing out of EZproxy

When you exit EZproxy, please close your browser completely.

Some databases have a maximum number that can access simultaneously. Please log out of the database when you have finished using it before you close your browser.

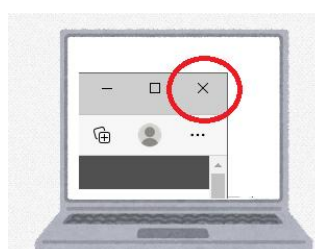

# How to use e-journals and e-books

## 1. Accessing the E-journal & E-book Portal

Refer to 1 - 2 on page 2 to access E-journal & E-book Portal via EZproxy.

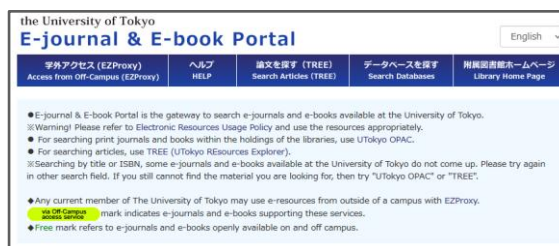

Enter the title of the e-journal or e-book you want to access in the search box and click the search button.

The search results will be displayed.

■ Check the available period.  
from ●● to ●●  
For each platform, the period available at the University of Tokyo will be displayed as described above.

■ Check the icon   
Only platforms with this green icon can be accessed from off-campus.

Clicking on the database name or platform name will take you to a page where you can read the e-journals or e-books.

Nature (London)  
ISSN: 0028-0836  
Look up Article  
Peer Reviewed  
1950 to 1996 in Nature Journal Archive  
1950 to Present in Nature Journals Online  
1990/01/04 to 1 year ago in Agricultural & Environmental Science Collection  
1997/06/05 to 2015/11/27 in Academic Search Complete  
2000/01/06 to 2021/12/23 in Gale Academic OneFile  
Gale General OneFile  
Search inside this journal Search

## 2. Signing out of EZproxy

When you exit EZproxy, please close your browser completely.



# Electronic Resources Usage Policy

Please use electronic resources appropriately. In the event of unauthorized use, the University of Tokyo may suspend the use of such electronic resources.

1. The electronic resources are available to members of the University of Tokyo (faculty, staff, students, etc.) and those approved by the library.
2. It is prohibited to use the electronic resources for purposes other than personal academic research and education.
3. It is prohibited to transfer any information acquired using this service to third parties.
4. It is prohibited to download a large amount of data or to access excessively. Regardless of the full text file, it is prohibited to download a large amount of data and to access excessively regarding all information on contracted databases, whether it is done manually or automatically.
5. Disable the link read-ahead function of your browser or application before using it.
6. You may be required to use a unique ID and password to access specific databases. It is prohibited to share such ID and password with anyone other than members of the University of Tokyo.
7. Adhere to the University of Tokyo Information Ethics Guidelines (<https://www.u-tokyo.ac.jp/adm/cie/ja/index.html>).

Please also see the following page for specific examples of unauthorized use.

<https://www.lib.u-tokyo.ac.jp/en/library/literacy/user-guide/campus/caution>

## Contact Information

**ASK Service** <https://opac.dl.itc.u-tokyo.ac.jp/opac/ask/?lang=1>

About how to use databases, e-journals and e-books.

**UTokyo Account** [https://utelecon.adm.u-tokyo.ac.jp/en/utokyo\\_account/](https://utelecon.adm.u-tokyo.ac.jp/en/utokyo_account/)

About UTokyo Account